



CLOSING

EC 101 KS CLOSING UNIT

Technical Data

Dimensions:	Length:	approx. 1800 mm
	Width:	approx. 1060 mm
	Height:	min. 1900 mm
	Infeed height:	min. 955 mm
Product dimensions:	Length:	max. 400 mm
	Width:	max. 200 mm
	Height:	max. 120 mm
Capacity:	60-100 packages / min (depending on the product and the drive unit mechanism)	
Controller:	Omron or Omron/Yaskawa	
Frequency controller or Servo inverter:	Hitachi or Omron/Yaskawa	
Power supply:	230/400 Volt / 50 Hz	
Power input:	2 kW	
Compressed air:	min. 6.0 bar (ISO 8573-1)	
Weight:	600 kg	

Available additional equipment:

- › Hot foil printer ,HPD' for labelling plastic clip tape
- › Separate drive unit and cycling unit for universal use (for manual and automatic feeding)
- › Product-specific machine design with inclination angles 20°, 30°, 45° or 60°
- › EC 101 K: Optional for product widths up to 360 mm
- › Compartment chain adjustable in width

GHD Georg Hartmann Maschinenbau GmbH

Schwalbenweg 24
D-33129 Delbrück, Germany
Tel: +49 (0) 52 50.98 43-0
Fax: +49 (0) 52 50.98 43-33

Web: www.ghd.net
E-mail: info@ghd.net



- › EC 101 H
- › EC 101 HS
- › EC 101 IS
- › EC 101 KS
- › EC 104
- › EC 108
- › EC 130
- › EC 135
- › EC 140
- › EC 140 S
- › EC 150 V





EC 101 KS Closing Unit

This closing unit was designed to be combined with vertical or horizontal flow wrapping machines. The continuous mode of operation of the unit requires both systems to be synchronized. The synchronization with the upstream packing machine can be achieved either mechanically with a chain or universal drive, or with an electronic shaft. The filled bags are transported to a closing unit positioned at a 90° angle with an inclination angle of 20°, 30° and optional with 45°, or 60 degrees. An integrated vacuum unit on the closing station evacuates excess air from the bags to be closed up and ensures consistently neat, taut packaging. The closure is done in the closing unit before out feeding.

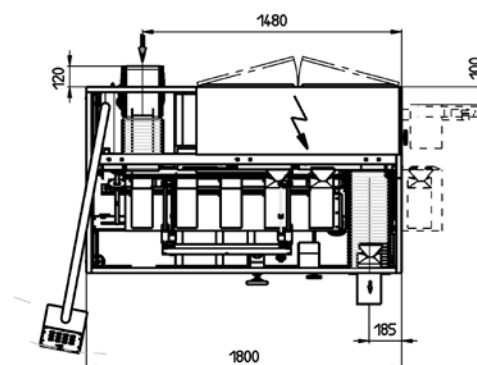
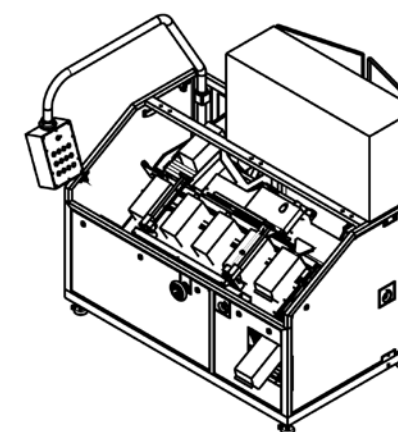
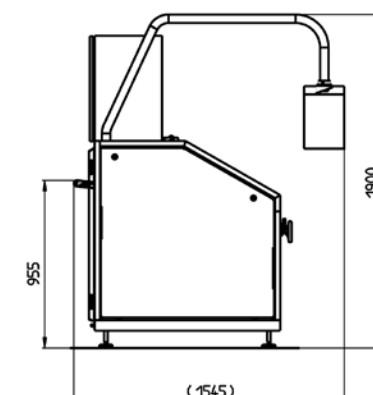
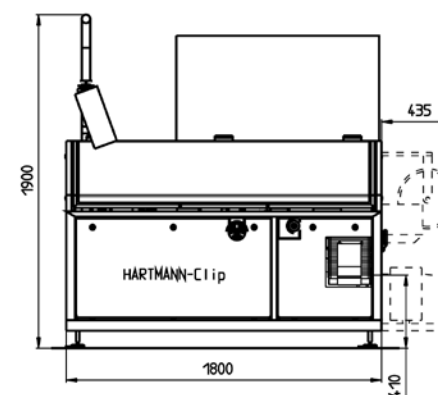
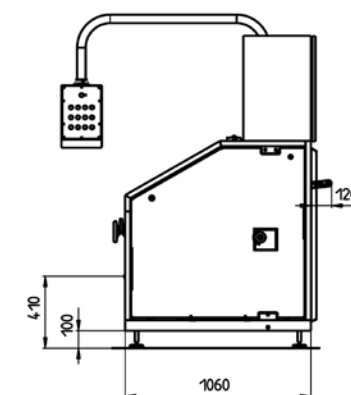

Non-binding suggested set-up drawing.



Optional: Printing unit

Hot foil printer 'HPD' for labelling plastic clip tape.

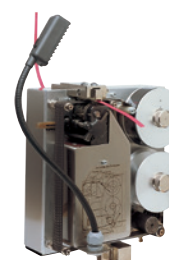

✓ EC 101 K

To fulfill customer-specific requirements and to operate with wider products, the EC 101 K, a longer version of the EC 101 KS can be delivered.

